



**MAINTENANCE TOOL KIT NOZZLES / SINGLE NOZZLE TYPE FN/FNH 1-2- NOZZLE TYPE FN 3-3B-3D**  
**KIT MANUTENZIONE UGELLI/ MONOUGELLI TIPO FN/FNH 1-2- UGELLI TIPO FN 3-3B-3D**

Consult the user and maintenance manual for instructions / Per istruzioni consultare il manuale d'uso e manutenzione

FN/FNH	1	1MD	1B	1GLT	1D	1DSL	1DSL	2	2MD	2P	2D	2DSL	2DSL	FN3	FN3B	FN3D
Ø 11	E15781	--	E15781	--	--	--	--	--	--	--	--	--	--	--	--	--
Ø 16	E19424	E19424	E19425	E19424	E19424	E19425	E19425	E19424	E19424	E19424	E19424	E19425	E19425	E19424	E19425	E19424
Ø 24	E19428	E19428	E19429	E19428	E19429	E19429	E19429	E19428	E19428	E19428	E19428	E19429	E19429	E19428	E19429	E19428
Ø 32	E19432	E19432	--	--	E19433	E19433	E19433	E19432	E19432	E19432	E19433	E19433	E19433	E19432	E19433	E19433
Ø 46	E19436	E19436	--	--	E19437	E19437	E19437	E19436	E19436	E19436	E19437	E19437	E19437	E19436	E19437	E19437
Ø 60	--	--	--	--	E19440	E19440	E19440	--	--	--	E19440	E19440	E19440	--	--	--

COMPOSED BY:

1. Disassembly tool for nozzle tip
2. Tool for thermocouple bending
3. Brush for cleaning tip hole in the nozzle core
4. Retractor tools for heater
5. Loctite grease

COMPOSTO DA:

1. Attrezzo smontaggio puntale
2. Attrezzo conformatura termocoppia
3. Scovolino per la pulizia alloggiamento puntale
4. Divaricatore per resistenza
5. Loctite antigrippante

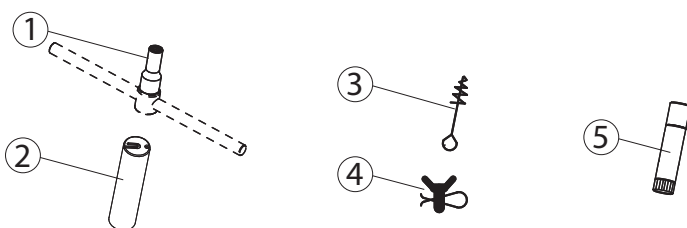

**MAINTENANCE TOOL KIT FOR SHUT OFF NOZZLES TYPE MO 3-3B-3D**  
**KIT MANUTENZIONE MONOUGELLI AD OTTURAZIONE TIPO MO 3-3B-3D**

Consult the user and maintenance manual for instructions / Per istruzioni consultare il manuale d'uso e manutenzione

MO	3	3B	3D
Ø 16	E19426	E19427	E19426
Ø 24	E19430	E19431	E19430
Ø 32	E19434	E19457	E19457

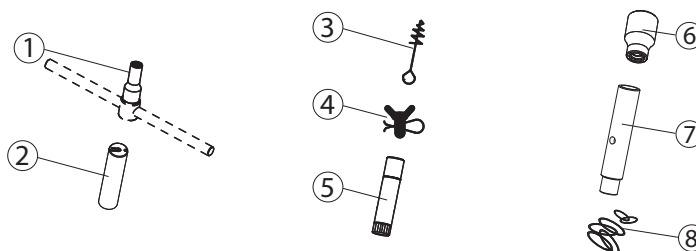

COMPOSED BY:

1. Disassembly tool for nozzle tip
2. Tool for thermocouple bending
3. Brush for cleaning tip hole in the nozzle core
4. Retractor tools for heater
5. Loctite grease
6. Wrench for closing and opening the ring nut
7. Disassembly tool for pin guide extraction
8. O-ring complete set

COMPOSTO DA:

1. Attrezzo smontaggio puntale
2. Attrezzo conformatura termocoppia
3. Scovolino per la pulizia alloggiamento puntale
4. Divaricatore per resistenza
5. Loctite antigrippante
6. Chiave apertura chiusura ghiera
7. Estrattore boccola guida spillo
8. Set completo O-ring



## MAINTENANCE TOOL KIT NOZZLES / SINGLE NOZZLE TYPE DN1/DN6 1-1B-2- NOZZLE TYPE DN3 KIT MANUTENZIONE UGELLI/ MONOUGELLI TIPO DN1/DN6 1-1B-2- UGELLI TIPO DN3

Consult the user and maintenance manual for instructions / Per istruzioni consultare il manuale d'uso e manutenzione

DN/DN6	1	1B	2	3
Ø 18	E17971	E17971	E17971	E17971
Ø 22	E17972	E17976	E17972	E17972
Ø 30	E17973	E17977	E17973	E19461
Ø 44	E17974	E17978	E17974	E17984

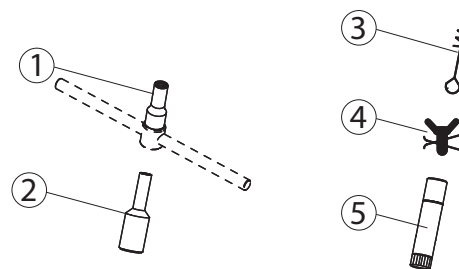

COMPOSED BY:

1. Disassembly tool for nozzle tip
2. Tool for thermocouple bending
3. Brush for cleaning tip hole in the nozzle core
4. Retractor tools for heater
5. Loctite grease

COMPOSTO DA:

1. Attrezzo smontaggio puntale
2. Attrezzo per lo smontaggio del nucleo
3. Scovolino per la pulizia alloggiamento puntale
4. Divaricatore per resistenza
5. Loctite antigrippante

## MAINTENANCE TOOL KIT FOR SHUT OFF GROUPS KIT DI MANUTENZIONE PER GRUPPI AD OTTURAZIONE

Consult the user and maintenance manual for instructions / Per istruzioni consultare il manuale d'uso e manutenzione

Gr. Ott.	KIT
<b>E18500</b>	E18520
<b>E19399</b>	E18521
<b>E18327</b>	E18523
<b>E18326</b>	E18524
<b>E18329</b>	E18525

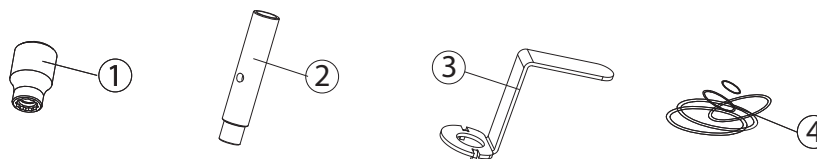

COMPOSED BY:

1. Wrench for closing and opening the ring nut
2. Disassembly tool for pin guide extraction
3. Wrench for pin stroke adjustment
4. O-ring complete set

COMPOSTO DA:

1. Chiave apertura/chiusura ghiera
2. Estrattore boccola guida spillo
3. Chiave regolazione corsa spillo
4. Set completo O-ring

## MAINTENANCE TOOL KIT FOR MULTI-TIPS NOZZLES KIT DI MANUTENZIONE PER UGELLI MULTIPUNTE

Consult the user and maintenance manual for instructions / Per istruzioni consultare il manuale d'uso e manutenzione

Nozzle type/Tipo ugello	KIT
<b>DL1 Ø18</b>	E19981
<b>DL1 Ø22</b>	E19982
<b>DL1 Ø30</b>	E19983
<b>DL1 Ø44</b>	E19984
<b>DN5/2</b>	E19985
<b>DN5/3</b>	E19986
<b>DL8</b>	E19987
<b>DL90 Ø18</b>	E19988
<b>DL90 Ø22</b>	E19989
<b>DL90 Ø30</b>	E19990
<b>DL90 Ø44</b>	E19991

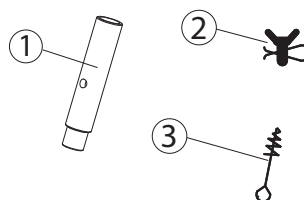

COMPOSED BY:

1. Disassembly tool for nozzle core
2. Retractor tools for heater
3. Brush for cleaning tip hole in the nozzle core (only for DL90 nozzle type)

COMPOSTO DA:

1. Attrezzo per lo smontaggio del nucleo
2. Divaricatore per resistenza
3. Scovolino per la pulizia alloggiamento puntale (solo per tipi DL90)